

# Transformer Tester

## 5265/5266/5267

### Features

- 20 channels
- Basic accuracy up to  $\pm 0.1\%$
- Support with Meter mode function, simultaneously display four parameters
- Pneumatic fixture F5620 built-in 100mA DC Bias
- Open circuit/short circuit function
- USB Host storage can save setting files, data and capture the screen
- Support RS-232, Handler, LAN, USB Host interfaces
- Using in transformer production line, quality assurance or incoming quality control department



CE RS-232 | Handler | USB Host | LAN | EXT. I/O

### Accessories / Fixtures

#### Standard

- Power Cord
- F5620
- Foot switch (F522010)

#### Optional

- PC Link software
- RS-232 cable
- Handler Box
- F423501 (5265)
- F423901 (5266/5267)
- FX-000C26

### Key Feature

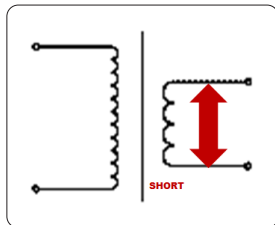
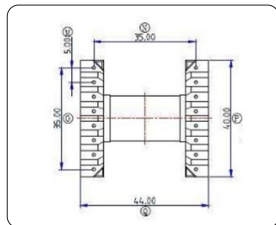

Measure leakage inductance



Customized fixture head

### Applications

Power transformer, electronic transformer

### Specification

Model Name	5265	5266	5267	
Test Frequency	10Hz-200kHz	10Hz-500kHz	10Hz-1MHz	
Channel	20			
Frequency Resolution	5 digits			
AC Drive Level	10mV-2Vrms			
Turn Ratio Frequency	50Hz-200kHz			
Output Impedance	100Ω			
LCR Function	●	●	●	
Fixture F5620	DC Bias 100mA			
Measurement Parameters	Inductance (L), Impedance (Z), Capacitance (C), Resistance (R), Conductance (G), Susceptance (B), Admittance (Y), Alternating Current Resistance (ACR), Quality Factor (Q), Phase angle (∅), Direct Current Resistance (DCR), Leakage Inductance, Turn Ratio, Balance, Short Circuit			
Parameters Measurement Ranges and Accuracy	Test Item	Range	Basic Accuracy (AC parameter : 1KHz)	Speed
	L, LK	0.1nH-9999.99H	0.1%	25ms
	C	0.00001pF-999.99mF	0.1%	25ms
	Q, D	0.00001-99999	0.0005	25ms
	Z, X, R	0.00001Ω-99.9999MΩ	0.1%	25ms
	Y	0.01nS-99.9999S	0.1%	25ms
	∅	-180°-+180°	0.03°	25ms
	DCR	0.1mΩ-99.999MΩ	0.1%	25ms
	Turn-Ratio	0.1-99999.9turns	0.5%	50ms
Pin-Short	12 pairs, between pin to pin	-	15ms	

### General

Measurement Mode	LCR + Transformer
Measurement Circuit	Series/Parallel
Correction	Open Circuit/Short Circuit
Built-in Storage	Testing files 128 sets
USB Host Storage	Depend on USB capacity
Operation	Auto, Manual, Remote Trigger
Interface	RS-232, Handler, LAN, USB Host, EXT. I/O
Power Supply	Voltage 98Vac-132Vac or 195Vac-264Vac Frequency 47-63Hz
Power Consumption	70VA
Display	800*480 Color Screen, 7" TFT
Environment	Temperature: 10°C-40°C, Humidity: 20-90%RH
Dimension (W*H*D)	344×145×343mm
Weight	9kg